

ROUND TAPERED

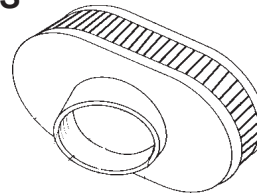

**AIR FILTERS**



OVAL SINGLE

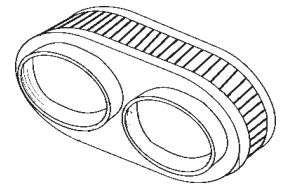

OVAL DUAL

PART#	STYLE	CAP TYPE	USE	F"	L"	D"	Engine	Price
SP2707	RT	RUBBER	ROTAX SILNCR	3 1/4	4 1/2	4 1/2	ROTAX with silencer kit	40.46
RA045V	RS	CHROME	BING 36	1 7/8	2	5 3/4	ROTAX all but 914	44.95
SP2706	RS	RUBBER	BING 36	1 7/8	2	5 3/4	ROTAX all but 914	43.20
RC0930	RS	CHROME	MIKUNI 32	2 3/4	3	5	KAWASAKI	49.95
RC1150	RS	CHROME	BING 36	2 1/16	3	3 1/2	ROTAX all but 914	39.95
RC1200	RT	CHROME	BING 36	2 1/16	4	3 1/2	ROTAX all 2 strokes	34.95
SP2704	RT	RUBBER	BING 36	2 1/16	4	3 1/2	ROTAX all but 914	28.54
RC1250	RT	CHROME	MIKUNI 32	2 1/4	4	3 1/2	CUYUNA	39.95
RC1350	RS	CHROME	BING 36	2 1/16	4	3 1/4	ROTAX all but 914	39.95
RC1950		CHROME	914 Turbocharger				ROTAX 914 turbocharger	41.95
RC2440	RS	CHROME	BING 36	2	2	5 3/8	ROTAX all but 914	42.95
RC2720	OD	CHROME	BING 36	2 1/16	3	8 1/2	ROTAX 503 dual carb	44.95
SP2705	OD	RUBBER	BING 36	2 1/16	3	8 1/2	ROTAX 503 dual carb	47.84
RC2820	OD	CHROME	BING 36	2 1/16	3	8 1/2	ROTAX 582 dual carb	44.95
SP2703	OD	RUBBER	BING 36	2 1/16	3	8 1/2	ROTAX 582 dual carb	47.84
RU0600	RS	RUBBER	MIKUNI 32	2 1/4	4	3 1/2	CUYUNA	32.95
RU0610	RS	RUBBER	MIKUNI 32	2 1/4	5	3 1/2	CUYUNA	34.95
RU0620	RS	RUBBER	MIKUNI 32	2 1/4	6	3 1/2	CUYUNA	34.95
RU0810	RS	RUBBER	BING 36	2 7/16	5	3 1/2	ROTAX 912 on Katana	32.95
RU1710	RS	RUBBER	BING 36	2 1/4	6	3 1/2	ROTAX 912S w/airbox	34.95
RC1950	RS	CHROME	BING 36	2 1/4	2	4 1/2	ROTAX 912	41.95
RU2690	RT	CHROME	BING 32	1 3/4	2	2 1/2	ROTAX Dual carb 377/447	32.95

**EA**

NOTE: SP STYLE FILTERS HAVE SAFETY WIRE TABS AND COME WITH SAFETY WIRE

OD = OVAL DUAL

F = INSIDE FLANGE DIAMETER

OS = OVAL SINGLE

D = OUTER DIAMETER OF FILTER

RS = ROUND STRAIGHT

L = DEPTH OF FILTER ELEMENT

RT = ROUND TAPERED



**FILTER OIL AND FILTER CLEANER**

**FILTER OIL**

SIZE	PART#	EACH
1 OZ.	KN010	4.95
6.5 OZ. SPRAY	KN0065	6.95
8 OZ SQUEEZE	KN0080	5.95
12 OZ SPRAY	KN0122	8.95

**FILTER CLEANER**

12 OZ.	KN120	7.95
32 OZ.	KN320	10.95
1 GALLON	KN640	27.58
CLEANER KIT W/ SQUEEZE OIL	KNRKS	12.95
CLEANER KIT W/ SPRAY OIL	KNRK	13.95

**FILTER CARE**

**1. PRE-CLEANING**

Tap the element to dislodge any loose embedded dirt, then gently brush with a soft bristle brush. (Note: If complete cleaning is not practical at this time, re-oil the element and re-install in your vehicle.)



**2. SPRAY ON CLEANER**

Spray K&N air filter cleaner liberally onto the entire element and let soak for 10 minutes.



**3. PAN CLEANING**

Large K&N elements can be rolled or soaked in a shallow pan of K&N air filter cleaner. Remove immediately and let soak for approximately 10 minutes.



**4. CLEANING HINTS**

Use only K&N air filter cleaner.

NO gasoline cleaning.

NO steam cleaning.

NO caustic cleaning solution.

NO strong detergents.

NO high pressure car wash.

NO parts cleaning solvents

Any of these NO's can cause harm to the gauze filter media, plus shrink and harden the rubber end caps.

**5. RINSE OFF**

Rinse off the element with low pressure water. Tap water is OK. Always flush from the clean side to dirty side. This removes the dirt and does not drive it into the filter.



**6. DRYING HINTS**

Always dry naturally. After rinsing, shake off all excess water and let the element dry naturally.

DO NOT USE COMPRESSED AIR. DO NOT USE OPEN FLAME. DO NOT USE HEAT DRYERS.

EXCESS HEAT WILL SHRINK THE COTTON FILTER MEDIA.

COMPRESSED AIR WILL BLOW HOLES IN THE ELEMENT.

**7. AEROSOL OILING**

After cleaning air filter always re-oil before using. Spray K&N air filter oil down into each pleat with one pass per pleat. Wait 10 minutes and re-oil any white spots still showing.



**8. SQUEEZE BOTTLE OILING**

After cleaning air filter always re-oil before using. Squeeze K&N air filter oil down into the bottom and along each pleat—only one pass per pleat. Let oil wick into cotton for 20 minutes. Re-oil any white spots still showing.



**9. OILING HINTS**

Never use a K&N air filter without oiling. (The filter will not stop the dirt without the oil.) Use only K&N formulated air filter oil.

K&N air filter oil is a compound of mineral and animal oil blended with a special polymer to form a very efficient tack barrier. Red dye is added to show just where you have applied the oil. Eventually the red color will fade but the oil will remain and filter the air.

NEVER USE Automatic Transmission Fluid NEVER USE Motor Oil NEVER USE Diesel Fuel NEVER USE WD-40, LPS, or other light weight oils.

# FUEL SYSTEM COMPONENTS

## FUEL FILTERS



Large area in-line filter for fuel. 1/4" fittings on both ends, comes with four clamps and two small pieces of black fuel line for splicing. 2 1/4" long body by 1 3/4" diameter. Paper element. **#414-3636 \$4.00**

EA



Small in-line type filter by K&N with sintered brass filter element. 7/8" diameter body by 1" long with 1/4" fittings on both ends. **#FF0-110 \$3.50**

Saucer type filter. Barbed fittings on both ends. 3/4" body length by 1 1/4" diameter. Brass mesh element, \$4.00 each. 5/16" barbs **#FF0-126**  
5/16" barb for oil only, **#4145365**



In-tank filter with spring, mounts on fuel line end. Metal with ball check. **#FFV-120 \$3.95**

## SHUT-OFF VALVES



180 DEGREE

### 1/4" HOSE BARBS

PART#	TYPE	EACH
SOV-120S	STRAIGHT IN LINE	\$7.96
SOV-125S	STR IN TANK, requires grommet	\$7.96
SOV-120P	STRAIGHT, IN DASH	\$9.95



90 DEGREE

### 1/4" HOSE BARBS

PART#	TYPE	EACH
SOV-120	90 DEG IN TANK, requires grommet	\$7.96
SOV-125	90 DEGREE IN DASH	\$9.95
8334	90 DEG IN TANK w/1/8NPS and filter	\$6.30

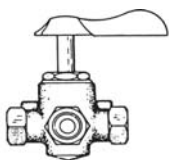

**SHUT OFFS, WITH FEMALE 1/8"NPT.** Order fittings separately for brass shut off's.

PART#	TYPE	EACH
SOV-130B	2-WAY, brass	\$12.95
SOV-150	3-WAY, brass	\$17.95
SOV-155	3-WAY, 1/4" aluminum	\$ 9.95



QUICK DISCONNECT

### IN LINE QUICK DISCONNECT

without shutoff. White delrin. **PART# TYPE EACH**  
QD14 NO SHUTOFF \$ 6.95



### HOSE FITTINGS, BARBED, THREADED

PART#	NPT	BARB	TYPE	SHAPE	MAKE	EACH
F001	1/4	1/4	BRASS	STRAIGHT	MALE	2.95
F001P	1/4	1/4	PLASTIC	STRAIGHT	MALE	.95
F002	--	1/4X1/4	BRASS	STRAIGHT	SPLICE	1.95
FFE-114	--	1/4X1/4	PLASTIC	ELBOW	MALE	.95
FFE-114B	--	1/4X1/4	BRASS	ELBOW	MALE	5.95
F002P	--	1/4X1/4	PLASTIC	STRAIGHT	SPLICE	.95
F003	1/8	1/8	BRASS	STRAIGHT	MALE	1.95
F005		1/8X1/8	PLASTIC	STRAIGHT	SPLICE	.95
F007	1/8	1/4	BRASS	STRAIGHT	MALE	2.95
F007P	1/8	1/4	PLASTIC	STRAIGHT	MALE	.95
F008	1/8	5/16	BRASS	STRAIGHT	MALE	2.95
F008-4	1/4	5/16	BRASS	STRAIGHT	MALE	2.95

## FUEL LINE

From Norton Plastics, the makers of Tygon tubing, comes **TYGOTHANE**, a specially formulated fuel line that has superior chemical resistance. It is also sturdy enough to be used as pulse line. Made in the USA. Clear only

SIZE	PART#	EACH
1/16"IDX1/8"OD	414413800	\$9.95/5 ft pc.
1/8"IDX1/4OD	FLU-180	\$.60/FT
1/4"IDX3/8OD	FLU-140	\$.70/FT
1/4"IDX7/16OD	FLU-140P*	\$1.60/FT
5/16"IDX3/8OD	FLU-516	\$1.25/FT
3/8"IDX9/16"OD	FLU-038	\$1.60/FT

\*PULSE LINE \*\*OIL INJECTION LINE

**VINYL HOSE**, clear, for ASI use only, 1/4" i.d., #FLV-140 \$.20/ft.

**VINYL HOSE**, clear, for oversleeving of tygothane when using metal clamps, 3/8" i.d., #FLV-038 \$.63/ft.



### Black automotive type fuel line, per foot:

3/16" id #FLB-316B, \$1.25  
1/4" id #FLB-140B, \$1.49  
5/16" id, #FLB-516B, \$1.69  
3/8" id, #FLB-516B, \$1.50  
6mm id, #FLB-6mm, \$1.35

## NYLON "SNAPPER" CLAMPS

Made of black or white nylon, these reusable clamps are easily installed and removed with a pair of pliers. \$.40 each, any size.

PART#	HOSE SIZE(OD)
HCS-010P	1/4
HCS-010F	3/8
HCS-010PL	7/16



## METAL HOSE CLAMPS

PART#	MIN	MAX	EACH
HCS-058	1/4	3/8	.96
HCS-114	11/16	1 1/4	1.35
HCS-112	13/16	1 1/2	1.40
HCS-134	13/16	1 3/4	1.45
HCS-020	1 1/16	2	1.50
CLAMP5W	5	5 1/2	7.95
CLAMP10*	3/8	27/64	.99
CLAMP13**	3/8	5/8	.95

\*Use with FLU-140, no oversleeve

\*\*Use with FLV-038 oversleeve



## FUEL FITTINGS

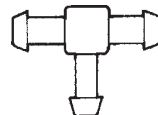

**FUEL T**, Delrin, #B = brass  
3/8x3/8x3/8 #FFT-38B \$6.39  
1/4x1/4x1/4 #FFT-114B \$4.95  
1/4x1/4x1/8 #FFT-148 \$ .45  
1/4x1/4x1/8 #FFT-148B \$2.49  
1/8x1/8x1/8 #FFT-118 \$ .50  
1/8x1/8x1/8 #FFT-118B \$2.95

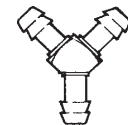

**FUEL Y**, Delrin  
1/4x1/4x1/4 #FFY-114 \$1.50

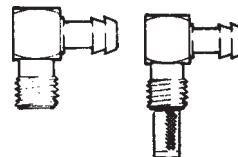

### IN TANK ELBOW, THREADED

Metal, with or without filter. 90 degree with 1/8NPS threads and 1/4" hose barb.

TYPE	PART#	EACH
w/out filter	8342	\$1.95
w/filter	8332	\$2.95

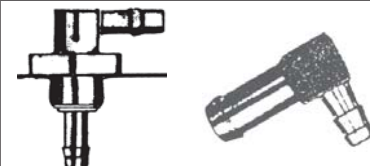

### IN TANK ELBOW, PUSH IN

Designed to push through a rubber grommet installed into tank. Grommet flares out to seal upon insertion of elbow. With or without internal tank 1/4" barb

TYPE	PART#	EACH
elbow	F011E	2.95
elbow w/ barb	F011EB	2.95
grommet	G001	.95

# FUEL SYSTEM COMPONENTS



## FUEL FITTINGS, FEMALE

PART#	NPT	BARB	EACH
F001F	1/4NPT	1/4	\$3.95
F003F	1/8NPT	1/8	\$1.95
F007F	1/8NPT	1/4	\$2.95
F008F	1/4NPT	5/16	\$2.95
F009F	1/4NPT	3/8	\$2.95



## FUEL FITTINGS, ELBOW

PLASTIC, BLACK, B=brass

PART#	NPT	BARB	EACH
FFE-38B	--	3/8x3/8	6.39
FFE-114	--	1/4x1/4	.95
FFE-114B	--	1/4x1/4	5.95
FFE-118N	1/8	1/4	.95
FFE-114N	1/4	1/4	.90
F0045E	1/4	5/16	3.95
F0046E	3/8	1/4	4.95
F0048E	1/2	1/4	4.95
F0064E	1/4	3/8	3.95



MKDF52



MKDF44

## FUEL PUMP REBUILD KITS, Mikuni original.

DUAL	#MKDF52	\$14.95
SINGLE	#MKDF44	\$8.95

EA



**PRIMER VALVE**, plunger type, dash mount. 1/8" fittings. #PRVALVE \$7.00

PRIMER KITS:	SINGLE	DUAL	912
CONTAINS:	#PKS \$21.95	#PKD \$26.95	#PKD912 \$59.95
PRIMER LINE	10'	10'	10'
PRIMER VALVE	1	1	1
1/4" CLAMP	2	2	4
1/8" CLAMP	5	8	--
ADAPTOR T	1	1	--
PRIMER T	--	1	--
BRASS ADAPTOR T	--	--	2
5MM LINE	--	--	3
13MM CLAMP	--	--	6
BRASS PRMR FITTG	--	--	2

**FUEL PUMPS, MIKUNI**, Manufactured specifically for aircraft engines by Mikuni. Both have vent holes, dual has bent fittings. Body does not go bad unless fittings are broken or case is cracked. Rebuild suggested.

SINGLE PUMP	#994-483	\$29.95
DUAL PUMP	#994-486 *	\$39.95

\*Fittings bent up, not to sides



**PRIMER BULB**, 5/16" fittings but will fit 1/4" line with a little elbow grease. Why? Because this is by far the best primer bulb we have found. High quality, durable, reliable. #PB14 \$14.95



**MR. FUNNEL**, filters water and other contaminants from fuel. Available in two sizes. FILTER FUEL BEFORE ADDING OIL. Additives can damage filter element. Replacement filters are not available.

SIZE	FLOW	PART#	EACH
3.5"	2.7 GPM	MF-350	14.95
5.5"	3.9 GPM	MF-550	17.95
8.5"	5 GPM	MF-850	24.95
8.5"	*12-15 GPM	MF-1250	49.95

\*Dual Element

## ELECTRIC FUEL PUMPS



**FACET ELECTRIC FUEL PUMPS**, work either with (in parallel) or replace your pulse type pump. Requires 1/8NPT male fittings.

PRESSURE	PART#	EACH
2-4 psi	FACET	42.95
4-6 psi	FACET1	49.95
4-6 psi	FACET2*	49.95
12v DC primer solenoid	B2DX62	95.00

\*this pump supplied with aircraft type outlets

Rotax recommends 5.8 max, 2.9 min on 2 strokes, 5.8 max, 2.2 min on 4 stroke engines



**DRAIN VALVES**, Curtis T type. Mount in bottom of fuel tank for preflight testing of fuel. Made in the USA.

THREAD	LENGTH	PART#	EACH
1/8 NPT	1	CCA-1250	14.95
1/8 NPT	1.358	CCA-1550	16.95
1/4 NPT	1.690	CCA-1600	16.95
3/8 NPT	2.00	CCA-1650	16.95
1/2 NPT	2.154	CCA-1700	16.95
12mm	1.45	CCA-2450	39.95
Angle adaptor	1.45 female thrd	CCA-2470	59.95

**DRAIN HOSES**: Attach to drain valve to avoid mess  
CCB-39600-2, for 1350,1650,4950 \$19.95  
CCB-39600-5, for 1250,1550, 4300,7450,9950 and 36750 \$19.95



**DRAIN VALVES**, SAF-AIR pin type. Mount in bottom of fuel tank for preflight testing of fuel. Made in the USA.

THREAD	LENGTH	PART#	EACH
1/8 NPT	.974	CAV-110	11.21
1/8 NP	w/1/4" hose ext	CAV-110H4	15.30
1/4 NPT	.974	CAV-160	11.21
1/8 NPT	.974	M12175	36.50



**DRAIN VALVES**, SAF-AIR pin type. Mount in bottom of fuel tank for preflight testing of fuel. Made in the USA.

THREAD	LENGTH	PART#	EACH
7/16-20	.974	CAV-170	14.10
3/8-24	.974	CAV-180	14.10



**GASCOLATOR** Made especially for homebuilt aircraft, this is an all metal gascolator with screen. It has a 1 7/8" cadmium plated steel bowl with quick drain and top casting has 1/4" ports for 3/8" fuel line and one 1/8" pipe port for primer fitting. Weighs 8 oz. #10580 \$89.95

REPLACEMENT GASKETS #10536-1 \$7.95  
REPLACEMENT SCREENS #10543-1 \$3.45  
GASCOLATOR BRACKET #10371 \$16.95



**FUEL TESTER** with screwdriver end. Works with both "T" and pin type sumps. Screw driver tip is reversible. Also marked for alcohol testing, #FT4 \$7.95.



**FUEL TESTER CUP** for pin type sumps. #FT2 \$5.95.

# FUEL SYSTEM COMPONENTS

EA



### UMA FUEL FLOW

1 1/4", #20-110F0800,0-60 gph, \$149  
 2 1/4", #20-21E00800,0-60 gph, \$188  
 Above pricing does not include transducer  
 Transducer, #201B-6, .6 to 60 gph \$255



Aeroquip socketless hose FC332 is for high temp applications. Great for fuel, lubricating oils, air and water. Do not use for hydraulic impulse apps. Max op psi = 250, Max burst psi = 1000. Blue in color.

i.d.	part#	/ft.
1/4"	AQPH4	4.30
3/8"	AQPH6	4.88
1/2"	AQPH8	4.04

FITTINGS	PART#	EACH
Reducer, 1/2-1/4NPT,male	AQP-12-14M	6.09
Reducer, 1/4-1/8NPT,female	AQP-14-18F	1.00
Reducer, 1/4-1/8NPT, male	AQP-14-18M	6.09
Straight fitting, 1/2NPT/barb	AQP12	3.95
Straight fitting, 1/8NPT,barb	AQP18	2.10
Elbow fitting, 1/2NPT/barb	AQP12B	3.95
Elbow fitting, 1/2barb/barb	AWP12BB	6.95
Adaptor, 1/2"npt/3/4UNF, stl	2021-8-8S	4.95
Adaptor, 1/2"npt/UNF, alum	ADAPT1/2-UNC	8.95



### Aeroquip Firesleeve

Good for heat insulation of fuel lines. Prices are per foot.

Part#	id	each
AQPFS4	1/4"	3.95
AQPFS6	3/8"	4.15
AQPFS8	1/2"	4.45
AQPFS34	3/4"	6.95
AQPFS114	1 1/4"	7.95

### Firesleeve clamps:

Exsm, #10781-4-12CR	2.99
Small, #10781-4-22CR	2.99
Large, #10781-4-32CR	2.99
Xlg, #10781-4-42CR	2.99



### SIPHON MATE Super Siphon!

Makes siphoning gas or water a breeze. Simply place in fluid to be siphoned, shake, and siphoning begins! #SIPHON \$8.00.

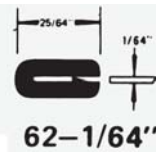

**TRIM**, Great for covering those rough edges on lexan, aluminum sheet, etc. Pebble type and smooth type finishes. Made of black rubber. Sold by the foot.

FINISH	WIDTH	SLOT	PART#	PER FT
Pebble	5/8"	1/64"	TR1*	\$.75
Smooth	5/8"	1/64"	TR1S*	\$.75
Smooth	1/4"	1/64"	TR2	\$.60
Smooth	Door seal trim, CT		TR4*	\$2.95

\*Aluminum reinforced



### FUEL TANK, 5 GALLON

Standard equipment on Drifter.  
 square tank = 11"Lx11"Wx12"H  
 tall tank = 9 1/2"Lx9 1/2"Wx13 1/4"H  
 Sq Tank #FT5-110 \$34.00  
 Cap #FT5-110C \$2.50  
 Tall Tank #FT5-120 \$28.95  
 Cap #FT5-120C \$2.00



**PENZOIL** Fuel system cleaner and stabilizer. 12 oz. bottle treats up to 12 gallons of fuel. Keeps stored fuel fresh. Can be used in 2 or 4 cycle engines. PZFS, \$2.99.



**PENZOIL** Fogging oil. Protects internal engine parts from rust and corrosion during seasonal and long periods of storage. PZFO, \$3.99

**DO NOT STORE FUEL FOR MORE THAN A MONTH. OCTANE RATING DROPS WHEN GASOLINE IS STORED. IF IT CONTAINS OIL (IF IT IS PREMIXED) IT WILL DEGRADE EVEN QUICKER. DRAIN ALL OLD FUEL FROM SYSTEM BEFORE ATTEMPTING TO START ENGINE, AND REPLACE WITH NEW FUEL. DON'T FORGET TO DRAIN THE CARBURETOR BOWLS AS WELL.**

**DUE TO EPA REGULATIONS, MOST FUELS CONTAIN SOME FORM OF ALCOHOL**



**RATIO RITE** oil measuring cup helps assure that you get the right mix of oil and gas the first time. Calibrated measurements mark the side. Lid is optional but recommended.

RATIO RITE	#RR1	\$3.75
LID	#RR1L	\$1.25

# OIL/COOLERS/RADIATORS



**Stop. Go. Pennzoil.**



**PENNZOIL 2-CYCLE OIL FOR AIR-COOLED ENGINES** is formulated with Pennzoil tough film base stocks and an additive package specially designed for air-cooled engines. Air cooled engines run hotter than water cooled outboard-type engines and require a lubricant formulated for their unique lubrication requirements. Outboard oils have a lower flashing point and tend to burn up early in air-cooled engines, causing carbonization and eventual ring sticking. Because of this, BIA, TC-W and TC-WII oils can promote the formation of deposits. Rotax recommends the use of a 2-cycle oil for air cooled engines as the optimum oil in most of their owner's manuals (all but the 618). Not only for the 277 through the 503, but also for the 532 and 582 liquid cooled engines. These liquid cooled engines run the same high internal temperatures as the air-cooled smaller engines and require the same high-temperature type of oil. Not compatible with TC-W or TC-WII lubricants. **DO NOT MIX THE TWO IN YOUR SYSTEM OR POSSIBLE GELLING WILL OCCUR.** Follow manufacturer's recommendation for mixing ratios. Pint, **#PZ80 \$1.89** or 24 half-pint case, **#PZ248 \$34.95.**



**PENNZOIL 2-CYCLE PREMIUM OUTBOARD OIL** is for 2-stroke engines with cooler internal temperatures. With a lower flash point, this oil is perfect for engines such as the 618 which run similar temperatures to those of an outboard type engine. Formulated for oil injection systems, it flows flawlessly. **DO NOT MIX WITH 2-CYCLE AIR COOLED OIL OR IT MAY GEL IN YOUR LINES.** Drain all oil out if you ever change oil types. **#PZOB, \$3.95/quart**

EA



**OIL FILTER CUTTER**, Kit includes one extra cutter wheel, sized for Rotax 825 701 filter. Minimum 3", maximum 4.5". **#FC2000, \$89.95.**



**ROTAX OIL FILTER** for 912/914 engines. Old style filter is gray, new style filter is black and has Rotax name and part# on the label. 825 012 \$19.95

## TANIS PRE-HEATER FOR ROTAX 9 SERIES

The Pre Heat consists of:  
 4 x cylinder head heating elements  
 1 x crankcase heating element  
 1 x oil tank heating pad  
 Wiring harness and installation hardware



Pre heat system plugs into 110V outlet and is designed to be run for 4 to 5 hours before engine start to fully preheat the engine. A cowl blanket is suggested for additional insulation and improved performance. Tanis preheat system can be left plugged in for prolonged periods without the risk of damage to the heating elements. Prevent engine damage and reduce wear during cold starts with the Tanis Engine Preheat System, **#TAS100-52, \$649.** 230 watt system also available.

**OIL LINE**, black. For use on oil systems or as coolant overflow. Made in Germany. Oil5 & Oil10 are braided, all other sizes are wrapped.



SIZE	PART#	USE	
5mm	OIL5	Overflow	2.95/ft
10mm	OIL10	oil inj tank	5.60/ft
11mm	956 530	RV line	69.53/meter
12mm	956 390	oil line,912	60.48/meter
17mm	922 250	coolant,912	58.19/meter



**OIL COOLER**, Standard equipment on the 912 Aircam and Drifter, this light-weight polished aluminum cooler is similar to the Rotax oil cooler in dimension. 11" long by 4 1/2" wide by 1 1/2" deep, this oil cooler is an attractive addition to any installation. Uses female 1/2" NPT fittings, not included. **#OILCOOL1 \$75.00**

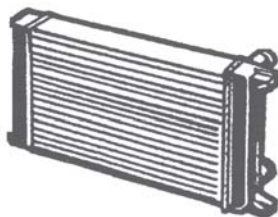

**RADIATOR**, Standard equipment on many homebuilt aircraft, this lightweight aluminum radiator is ideal for economical installations. Measuring 23" long by 13" wide by 1 1/2" thick, it has more than enough cooling surface for the hottest of engines. Weighs only 4.5 lbs. Comes with plug. Headertank required, not included. Uses 1" 1/4" id hose, not included, or can be sized down with **#F014 splice to 1"**, not included. **#RADA \$125.00**

<b>RADIATOR HOSE, 1"</b>	<b>#RADH</b>	<b>\$1.99/FT</b>
<b>3/4"</b>	<b>#RAD34</b>	<b>\$1.85/FT</b>

### PVC HOSE FITTINGS

1"x1"x1" T	#F010	\$2.25
1"x1" ELBOW	#F012	\$1.95
1"x3/4" SPLICE	#F013	\$1.50
1"x1 1/4 SPLICE	#F014	\$1.95
1"x1" SPLICE	#F015	\$2.95
1"x1" ELBOW	#F015HT*	\$10.95
*HIGH TEMP TOLERANCE FOR 9 SERIES ROTAX		

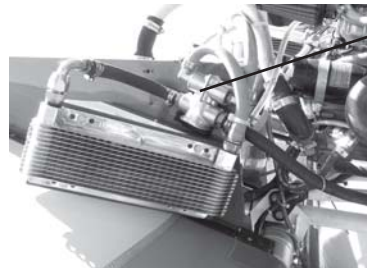

**#OILCOOLTH, \$55.95**

### OIL COOLER THERMOSTAT

Great for regulating the oil temp on 912/914. For use in applications where a minimum oil temp of 180 F/ 82C cannot be maintained. When oil temperature is less than 180-190F (82-88C) the oil cooler is bypassed. Once this temp is reached, the thermostat will force the oil to flow through the cooler. 4 fittings are required and included with kit, please specify quantity of straight and/or bent fittings you need. Especially useful for cold weather flying. More effective than blocking off the cooler with baffles.

## OIL INJECTION/THROTTLE

503 OIL INJECTION TANK INSTALLATION

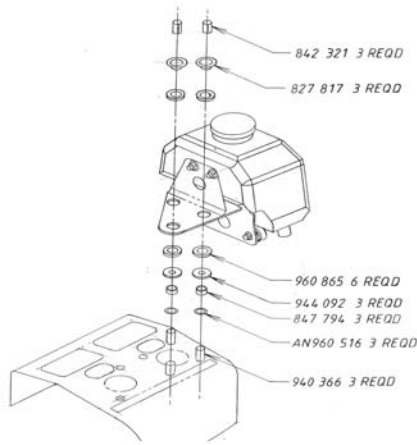

503 END MOUNT

# ROTAX

OIL INJECTION TANK, Rotax original equipment. Recommended for Rotax 503, 582 and 618 oil injected engines. Brackets available for 503 and 582 only. Tank has Rotax logo and connections for low level indicator light.

ITEM	PART#	EACH
OIL INJECTION TANK ONLY	881-460	150.99
OIL INJECTION TANK, 582 WITH SIDE MOUNT BKTS	881-465	173.99
OIL INJECTION TANK, 503 WITH END MOUNT BKTS	881-46503	199.95
OIL INJECTION TANK WITH END MOUNT, 582	881-46582	199.95
END MOUNT BKTS, 503&HW	OITEM503	89.95
END MOUNT BKTS, 582&HW	OITEM582	89.95

ALSO AVAILABLE FOR FREE AIR, PLEASE SPECIFY

**REMEMBER:**  
**THIS OIL INJECTION SYSTEM IS GRAVITY FED. ALWAYS MOUNT TANK ABOVE ENGINE.**

**DO NOT MIX OILS! OILS FLOW WELL UNTIL MIXED WITH ANOTHER GRADE, THEN THEY MAY GEL AND CLOG UP YOUR INJECTION SYSTEM.**

EA

## OIL INJECTION/THROTTLE CABLES

Necessary for the actuation of carburetors, remote choke, oil injection and RAVE valves. Lengths shown are for housing, cables extend further, extended length depends upon application.

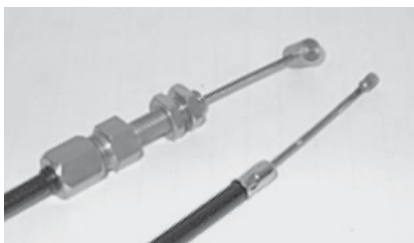

OIL INJECTION AND THROTTLE CABLES



SPLITTER HOUSING W/SLIDER

TYPE	PART#	EACH
10" throttle cable w/carb end	THR10*	\$12.95
15" throttle cable w/carb end	THR15*	\$14.95
17" throttle cable w/carb end	THR17*	\$15.95
2 way splitter w/cables, for any dual carb Rotax but 912	SPL2WY	\$24.95
2 way splitter w/cables for choke	SPL2WYC	\$24.95
2 way splitter w/cables for RAVE618	SPLR618	\$49.95
3 way splitter w/throttle and oil injection cable for 503	SPL3WY503	\$34.95
3 way splitter w/throttle and oil injection cable for 582/618	SPL3WY	\$34.95
Splitter housing only, 503/582/618	SPLHSG	\$ 5.95
Splitter housing only, 912	SPLHSG912	\$ 7.95
Oil injection cable only, 503	SPLOI03	\$14.95
Oil injection cable only, 582	SPLOI82	\$11.95
Oil injection ferrule ss, 503	OIF503	\$ 1.95
Oil injection ferrule ss, 582	OIF582	\$ 1.95
Brass throttle ferrule for 1/16" cbl	TF1	\$ .30
Chrome end cap for housing	BR08	\$ .20

**WE CUSTOM MAKE CABLE ASSEMBLIES GIVE US A CALL! ALL 912 CABLES MUST BE CUSTOM MADE, CALL FOR DETAILS**

\*Do not include housing, cable w/end only, please order separately

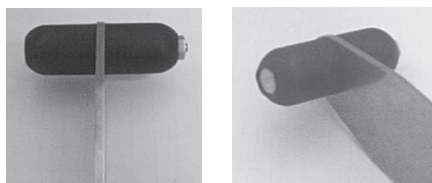

**THROTTLE KNOBS**, absolutely the least expensive throttle available. Made of black nylon, they are both attractive and durable. Recess on ends for nut and bolt head to mount flush. All it takes is 2 of our injection molded knobs, one 3/16" bolt and one AN365-1032 nut, and whatever material you choose for an arm. Bolt and nut sold separately. Please specify material width of arm, this determines the bolt length. Throttle knob, **#CS66 \$ .95** each.



**STAINLESS WIRE**, .062, stainless steel. Great for trim cable. #MW55 \$.20/ft. Use CC-1 cable housing, black.

## ELECTRIC FLAP MOTOR

**SCREW DRIVEN**



12V flap motor, ideal for homebuilts. Std equipment on the Aircam twin. Lightweight and durable. Wiring not included. **#FLAPM1 \$399.95.**

**ACCEPTS STD ROD END**

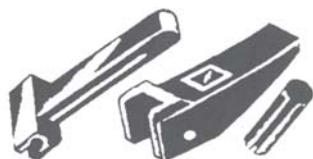

**DAYCO SWITCH**, for choke actuation. Mounts in dash in 5/8" hole. #995-685 \$52.87



**EXTERNAL REVERSING HOOK-UP**  
 Can be used in tandem for dual control.  
 Weight = 10 oz  
 Body = 2 3/4" x 4 3/4"  
 TYPE PART#  
 SINGLE LEVER, REV #1R \$49.00  
 TWO LEVER, REV #2R \$52.00  
 THREE LEVER, REV #3R \$57.00  
 Add -F to part# for friction, +\$7 upgrade

**THROTTLE/FLAP/TRIM**

**INTERNAL REVERSING AND NON-REVERSING HOOK-UP**  
 Reversing weight = 10oz, 2 3/4x4 3/4  
 Non-rev weight = 12oz, 4x4  
 SINGLE LEVER, REV #1RI \$49.00  
 SINGLE LEVER, NON #1NRI \$49.00  
 TWO LEVER, REV #2RI \$52.00  
 TWO LEVER, NON RV #2NRI \$52.00  
 THREE LEVER, REV #3RI \$57.00  
 THREE LEVER, NONRV #3NRI \$57.00  
 Add -F to part# for friction, +\$7 upgrade



**EA**

**PANEL MOUNT REVERSING AND NON-REVERSING HOOK-UP**



Weight = 10 oz  
 Body = 4" x 3 1/2"  
 S series only  
 TYPE PART# EACH  
 SINGLE LEVER, REV PM1RI \$49.00  
 SINGLE LEVER, NON PM1NRI \$49.00  
 TWO LEVER, REV PM2RI \$52.00  
 TWO LEVER, NON PM2NRI \$52.00  
 THREE LEVER, REV PM3RI \$57.00  
 THREE LEVER, NON PM3NR \$57.00  
 Add -F to part# for friction, +\$7 upgrade



**RV4 NON-REVERSING**  
 Weight = 11 oz.  
 Body = 4" w x 3.5" tall  
 For use on RV3 and 4 aircraft,  
 S Series only  
 TWO LEVER RV4F2 \$60.00  
 THREE LEVER RV4F3 \$65.00  
 Available only with friction  
**TWIN ENGINE, 4 ARM**  
 Weight = 13 oz.  
 Body = 4 7/8" wx4" tall  
 Internal only, reversing or non.  
 Internal non revers #TL4RI-F, \$75.00  
 Internal reversing #TL4NRI-F \$82.00

**NO HARDWARE OR CABLE INCLUDED, PLEASE ORDER SEPERATELY.**

**MULTIPLE SIZES AVAILABLE**

All above quadrants (not PM or RV type) are available in large, standard, 3/4 and 1/2 sizes. All quadrants are made with AN standard hardware and aircraft quality 6061T6 or 2024T3 aluminum. All sizes can be utilized for a side mount, center mount or dual control hookup. Four sizes available:  
 L series (large) 4 7/8" wide x 4" tall, 13 oz., \$5 upgrade over above listed prices  
 S series (standard) 4" wide x 3 1/2" tall, 11 oz., prices as listed above  
 3/4 series, 3 7/8" wide x 3" tall, 10 oz., prices as listed above  
 1/2 series, 3 7/8" wide x 2 5/8" tall, 8 oz., prices listed as above  
 To order use above prefix (L,S, 3/4 or 1/2) in place of #, example: S2R-F for standard 2 lever reversing quadrant with friction.



**THE CLAW**  
 Tie down system, includes all items shown, #CLAW \$99.95

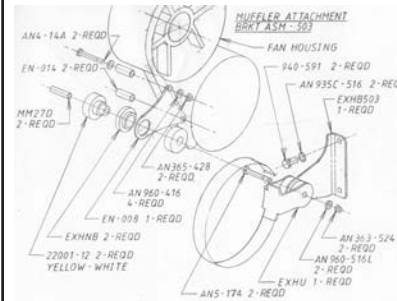

**EXHAUST MOUNT KITS**  
 Kits mount exhaust down only. Stainless clamps and brackets. 503 type shown.  
 EMK503, \$109.95  
 EMK582, \$109.95

**Rotax 912 & 912S**



**Exhaust clamp kits**

Eliminate exhaust springs with these handy clamp kits. 1 kit required per joint. Kits come with items shown. Modification of joints may be required for installation.

912 clamp kit, EXHCK912 \$42.95  
 2 strokes clamp kit, EXHCK \$39.95

**Rotax & Hirth 2-Stroke**





**BARRY MOUNTS**, used for engine and muffler mounts. Standard equipment on many homebuilt aircraft. 2 halves per mount.

TYPE	PART#	EACH
RED/SOFT	22001-11	9.95
YELLOW/MEDIUM	22001-12	9.95
GREEN/HARD	22001-13	9.95
BLUE/HARDEST	22001-14	9.95
GREEN, FOR 912	22002-13	11.95

## ENGINE/MUFFLER MOUNTS

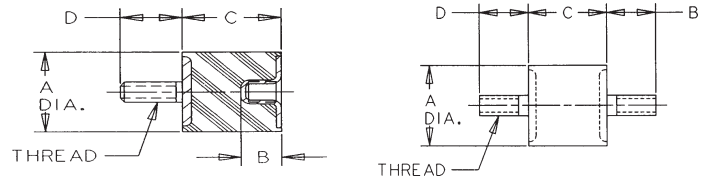

**LORD SANDWICH MOUNTS**, great for installing everything from mufflers to gauges. Oil resistant rubber.

TYPE	THREAD	A	B	C	D	EACH	PART#
MALE/MALE	6-32	.38	.38	.5	.38	6.95	SM06
MALE/MALE	8-32	.38	.38	.50	.38	4.95	SM08
MALE/MALE	10-32	.38	.38	.50	.38	4.95	SM01
MALE/MALE	1/4-20	1.0	.25	.75	.50	4.95	SM02
MALE/MALE	5/16-18	1.0	.88	.75	.50	4.95	SM03
MALE/MALE	5/16-18	1.5	.75	1.0	.75	5.95	SM04
MALE/MALE	8MMX1.5	1.0	.60	1.0	.63	3.25	SM04M
MALE/FEMALE	1/4-20	.62	.25	.62	.50	4.95	SM02F

EA

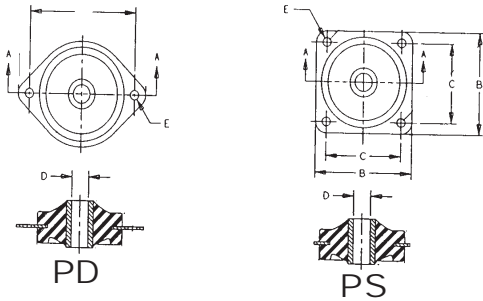

**LORD PLATE MOUNTS**, square (PS) and diamond shaped (PD) are used mainly as engine mounts when the engine is mounted on a plate. Both shapes come with predrilled rivet or screw holes for installation. 1/4" hole in all. Steel plate.

SHAPE	THICKNESS	PART#	EACH
Diamond	.88	PD-24	\$9.95
Diamond	1.12	PD-30	\$9.95
Square	.88	PS-24	\$9.95
Square	1.12	PS-30	\$9.95

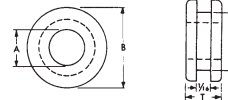

**GROMMETS**, used for mounting console panels, pitot tubes, fuel tank fittings, protecting structures from pass thru of wires, cables, etc. Buna S.

A	B	D	PART#	EACH
3/16	1/2	5/16	G500	.16
7/16	3/4	9/16	G501	.23
1/8	11/32	1/4	G502	.10
1/8	1/2	3/8	G503	.20
3/16	7/16	9/32	G504	.16
1/4	5/8	7/16	G505	.16
1/4	1/2	3/8	G506	.15
1/4	1/2	3/8	G507	.15
5/16	13/16	9/16	G508	.29
5/16	5/8	7/16	G509	.16
5/16	5/8	7/16	G510	.19
3/8	7/8	3/8	G511	.31
3/8	5/8	1/2	G512	.14

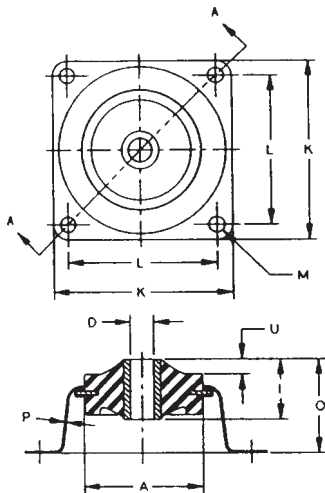

**QUICKSILVER TYPE** motor mount, cup type. Black rubber with flange around center hole. 2 sizes available:

	#61035	#61036
A	1.5"	2.0"
D	.257"	.391"
K	2.38"	3.0"
L	1.938"	2.5"
M	.196"	.257"
Q	1.945"	2.475"
P	.032"	.032"
U	.18"	.22"
	\$16.66	\$19.11

**QUICKSILVER TYPE** motor and exhaust mounts. Black rubber with flange around center hole. Previously #30380. **#G004 \$1.95**

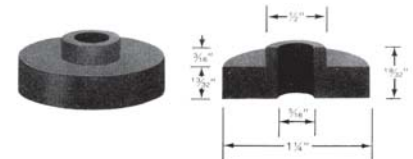

### CARB HEAT SYSTEM

The carb heater is suitable for fitting to Rotax 912 UL and 912 ULS series engines. In operation the carburettor heater adds a small amount of heat to the carb body at its downstream end in order to keep the temp of the body above freezing point. The intention is that any ice formed will not adhere to the carb throat. Because the heater block is adjacent to the throttle spindle, some heat is also transferred through the spindle to the butterfly, to prevent a thick build up of ice on the butterfly, which with the type of carburettor used, can be a cause of rough running and possible engine failure. Because there is no significant heating of the intake air when hot coolant is circulating through the carb heater blocks, there will be a negligible loss of full engine power. The system has not been tested under all possible conditions that may prevail, therefore its effectiveness cannot be guaranteed in all circumstances. Aircraft equipped with this device should never be flown in circumstances where a successful 'no power' landing can't be made in the event of engine failure.

Carb heat cast type #CarbHeat-3, \$415

Carb heat machined type #CarbHeat-2, \$415





**SPARK PLUGS**

TYPE	ENGINE	EACH
B8ES*	277-582	2.40
BR8ES*	618	2.40
BR8EIX**		7.95
DCPR7E***	912	2.95
DCPR8E***	912S	2.95
X27EPR-U9***	914	2.95

\*SOLID CAP PLUGS, NOT SCREW ON CAP  
 \*\*REPLACES BR8EV  
 \*\*\*SCREW TYPE REMOVEABLE CAP



**PLUG CAPS**

TYPE	PART#	EACH
MAGENTA	866-705	26.34
BLACK	LB05EZ	3.95

EA

**SPARK PLUG GAPPING for Rotax aircraft engines only**

277,377,447,503,532 point ignition	.018"
503DCCDI, 582,618	.018"
912, 912S, 914	.028"

**SPARK PLUG WIRES/SHIELDING**

ITEM	PART#	PRICE
Plug wire, 2 strk	965 153	\$15.61/meter
Plug wire, 4 strk	865 710	\$35.41/meter
Shielding	SHLDG	\$2.25/ft



**PLUG CADDIES**, great way to store spark plugs either in the plane, your car or your suitcase. Black durable nylon. Two plug #PLGCAD \$2.99



**SVA-2-100**  
**\$11.95/pair**



**SVF325A, \$13.95/pair**  
**SVF318, \$13.95/pair**



**SVCC3251, \$13.95/pair**  
**retractable type**



**STARTER ROPE**, Durable nylon, non-stretch. #ROPEST \$.60/ft.

**FOR ROTAX ELECTRIC STARTERS AND WIRING SEE "STARTERS" SECTION UNDER "ROTAX" OR THE INDEX**

# LOCKWOOD

AVIATION REPAIR, INC.

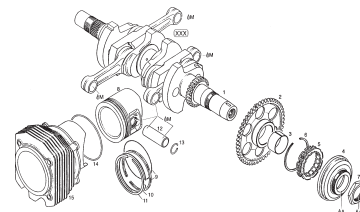

independent **SERVICE CENTRE**  
**ROTAX**  
 AIRCRAFT ENGINES

- \*QUALITY SERVICE
- \*FAST TURNAROUND
- \*15 YEARS OF 2-STROKE EXPERIENCE AND AN A&P/DAR ON STAFF
- \*CERTIFIED AND UNCERTIFIED ROTAX ENGINE REPAIR AND MAINTENANCE
- \*912/912S/914 QUALIFIED SERVICE

**YOUR SATISFACTION IS OUR BUSINESS!!**

PHONE:863-655-6229/FAX:863-655-6225

e-mail:info@lockwood.aero

# PROPELLERS

## Warp Drive

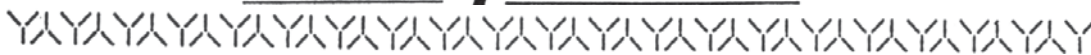

EA



**3 BLADE WITH TAPERED TIPS**



**PROTRACTOR #WARPPRO \$35.00**

WARP DRIVE PROPS are built using only carbon fiber. There are no foams, no fiberglass and no gelcoat used in these propeller blades. The structural and practical advantages of carbon fiber over wood or fiberglass, wood or metal prop are superior strength, relatively light weight, durability and longer useful life. Construction of these propellers allows for easy repair of nicks and gauges that sometimes happen. The blades are also individually replaceable. All are ground adjustable and a protractor comes with every prop to assist in proper settin of blade pitch. Leading edge tape is standard with every kit. Nickel edge is also available. Each one is serial #'d so that if you lose a blade for whatever reason, it is traceable and replaceable by Warp Drive using this number only. Each prop comes with a lifetime "Guarantee of satisfaction".

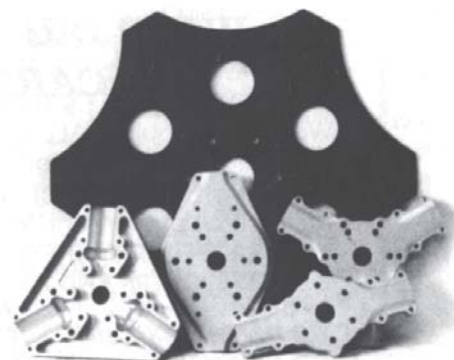

**WHICH HUB TO USE??!**

**STANDARD HUB:** 2 strokes with 75mm bolt pattern, use 8mmx90mm (3 1/2") bolts

**HPL HUB:** for 912/914 and some Subaru installations Can be used on 2 strokdes in place of standard, saves 1 lb on 2 blade installations and 1 1/2 lb on 3 blade installations, use 8mmx75mm (3") bolts

**HP HUB:** for Continental/Lycoming engines, use AN6-35A bolts with face plate

**STANDARD CARBON FIBER PROPS**

- 2 blade standard
- 3 blade standard
- 4 blade standard
- 5 blade standard
- Replacement blade \$169

STD HUB	HPLHUB	HPHUB	OS
\$419	\$549	\$599	
\$599	\$779	\$779	
\$799			\$949
\$959			

**HIGH HORSE POWER CARBON FIBER PROPS**

- 2 blade HP
- 3 blade HP
- 4 blade HP
- 5 blade HP
- 6 blade HP
- Replacement blade \$239

HP HUB	OVERSIZE
	\$749
	\$989
	\$1259
	\$1489
	\$1719

**OTHER PROPELLER OPTIONS**

- Nickel leading edge, per blade
- Custom colors, per blade
- White tips only, per blade
- Mounting hardware, Rotax
- Non-standard hub pattern
- Face plate - 4" SAE I, SAE II Patterns
- Blade blocks, pair
- Taper, per blade
- Urethane edge tape, each
- Extension, 2 1/2", 914 pattern

PART#	PRICE
WARPNE	\$59
WARPCC	\$39
WARPWT	\$15
WARPBLT	\$12
WARPSH	\$39
WARPFSAE	\$49
WARPBB	\$19
WARPTT	\$59
WARPUT	\$4
WARPEXT	\$320

**SPINNERS, ALUMINUM**

SPINNERS, ALUMINUM	SUGGESTED USE	EACH
4" spinner, #SPINH	All HPL hubs	69.95
5" spinner, #SPINH5	2 blade Std or 100mm HPL	99.95
6 3/4" spinner, #SPINW6	3 blade Std,HP/ALL SAE 1&2, not for 912/912S or 914	130.00

**SPINNERS, FIBERGLASS**

8", #SPNW6F	2 blade HPL	100.00
9", #SPINW9	3 blade HPL	175.00
10", #SPINW10	3 blade Std & HP	199.00
14", #SPINW14	3 & 4 blade Oversize	225.00

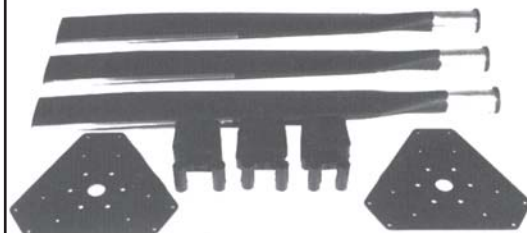

**3 BLADE WITH STANDARD HUB**

**NICKEL EDGE & TAPER TIP ADD TO LEAD TIME CALL FOR CURRENT AVAILABILITY**

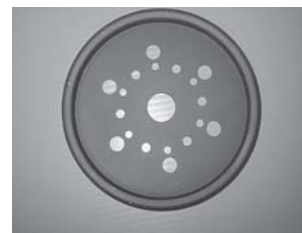

**PROP BALLANCER**, mounts to PTO end of engine. For 2-strokes only. #PROPBAL2, \$64.95

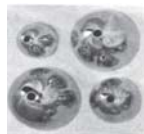

**ALTERNATOR KIT FOR 912, 40 amps**

**External alternator kit** comes with all necessary components other than wiring. It allows the owner of a Rotax 912 to achieve extra amperage for accessories. the external alternator is driven by a pulley/belt setup which is attached to the standard 912 prop flange. We have also machined an extra belt groove in the prop flange pulley which could be used for another belt driven device, such as a vacuum pump. The complete assembly weighs less than 9 lbs. #ALT912 \$995

## IVO IN-FLIGHT ELECTRIC-ADJUST PROPS

The ability to change the pitch in flight is as significant for the airplane pilot as for the driver of a car to shift gears in the transmission. This results in substantial savings in fuel, engine wear and noise. The Ivo In-Flight Adjustable prop works the following way:

\*Pilot controls the pitch through the toggle switch mounted in the cockpit. Pressing the toggle switch one way sends electric current through the graphite brushes to the slip rings and finally to the electric motor.

\*Depressing the toggle switch the other way reverses the polarity of the current and the rotation of the electric motor. The pitch change operation is similar to the power windows in an automobile. As long as you hold the switch in one direction, the pitch changes in that direction and you observe the result on your RPM meter.

\*Torque from the electric motor is multiplied in a two-stage planetary gear drive which turns the lead screw.

\*Lead screw is supported by a thrust bearing and converts its rotary motion into axial movement of the spool.

\*The spool is linked to the supercams which turn the torsional rods. Torsional rods transmit the movement from the center of the prop to the outside section of the blade. This causes the blade to twist and therefore changes the pitch in the same manner as the ground adjustable pitch system.

\*Total time required for the full range of adjustment is about 5 seconds.

\*Movement of the spool can be restricted each way by inserting washers on the lead screw. This limits maximum and minimum pitch and prevents engine over-revving.

\*Mounts directly to any Rotax gear box, B,C, E models. Can be adapted to VW, Subaru, Hirth or Arrow.

\*Older model Ivoprop ground-adjustable props can be converted to the In-Flight adjustable system by means of a retrofit kit.

Torsional rod must be offset toward the leading edge of the prop. **Early model props with the torsional rod located in the direct center of the blade cannot be converted.**

\*In-flight adjustable hub comes assembled with instructions on how to use it.

\*Total weight of 3 blade 72" diameter in-flight adjustable Ivoprop including wire harness, spinner, control switch, mounting hardware, and the circuit breaker is 8.75 lbs.

**2-blade in-flight adjustable prop**

**\$999.00**

**3-blade in-flight adjustable prop**

**\$1149.00**

**Retrofit kit**

**\$699.00**

**Replacement blades**

**\$150.00 for one blade**

**\$140.00 each for 2+ blades**

EA

### In-Flight Adjustable Pitch Ivoprop

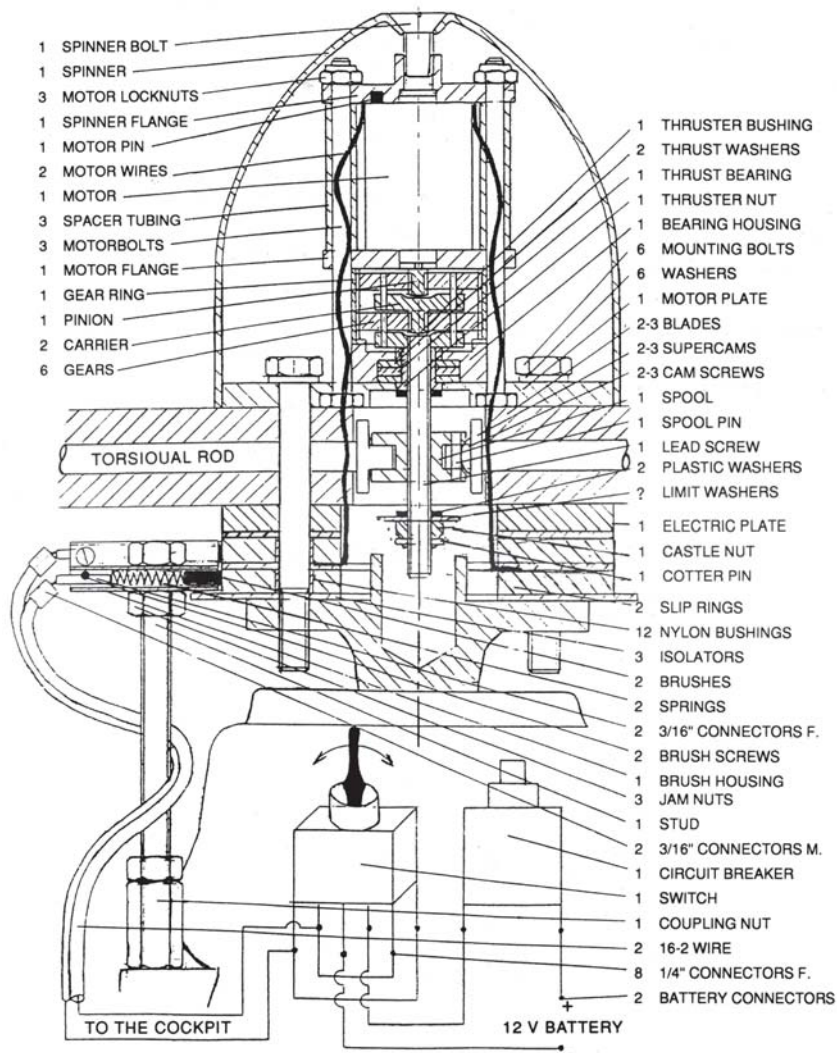

# IVOPROP



#### SPINNERS, SPUN ALUMINUM

Available for in flight adjust and quick adjust props. 4", comes with left hand threaded mount bolt, \$40.00

#### TYPE

Quick adjust  
Electric adjust

#### PART#

SPINIQ  
SPINEA  
Standard adjust spinner discontinued

# IVO QUICK-ADJUST PROPS

# PROPELLERS

Adjust the pitch on the ground in a matter of seconds by turning the screw adjustor in the center of the prop. The supercams are installed on the square end of the torsional rod. Each supercam fits into the groove in the screw adjustor. Turning the screw adjustor causes each cam to rotate and turn the torsional rod and thereby twist the blade changing the pitch. Available in lengths from 48 to 72" in diameter.

- 2-blade quick adjust prop \$ 399.00
- 3-blade quick adjust prop \$ 579.00
- 6-blade quick adjust prop \$ 1149.00

NOTE: New quick adjust cams are welded on blades, not glued.



EA

### MEDIUM MAGNUM PROPS

- \*Sized between UL and Magnum props
- \*Ideal for engine around 100 hp or high ratio gear boxes
- \*Available in 52" - 74" diameters
- \*Good for fast airplanes, has scaled down magnum shape
- \*Available in 30"-90" pitch
- \*Currently available in left hand rotation only

**MAGNUM HIGH-HORSEPOWER PROPS**, wide blades and big hub for engines up to 700 hp.

### FEATURES:

- \*30"-90" pitch range
- \*58-76" diameter
- \*6 blade model for engines up to 700 hp
- \*Ground adjustable is upgradeable to in-flight adjustable system (blades and part of the hub will remain the same)



### Quick adjust system:

2 blade	11.2 lbs	\$799.00
3 blade	14.2 lbs	\$999.00

### In flight adjust system:

2 blade	15.7 lbs	\$1195.00
3 blade	19.2 lbs	\$2449.00
Retrofit kit	6 lbs	\$1579.00
Constant speed option		\$ 319.00

PROP	PART#	EACH
2 BLADE QUICKADJ	IVOM2G	999.00
3 BLADE QUICKADJ	IVOM3G	1349.00
6 BLADE QUICKADJ	IVOM6G	2399.00
2 BLADE ELECTRIC	IVOM2E	2399.00
3 BLADE ELECTRIC	IVOM3E	2749.00
6 BLADE ELECTRIC	IVOM6E	3949.00
Retrofit kit for Electric	IVOME	1549.00
Paddle blade, per blade	IVOMP	89.00
Leading edge for paddle blade, st. stl, per bld	IVOMPL	42.00

### REPLACEMENT BLADES:

1 BLADE	259.00
2 OR MORE BLADES (EACH)	239.00

Colors no longer available, black only.



**STAINLESS STEEL TAPE**, great for leading edge tape, shimming, scuff patches, etc. Only new thin tape is available. If you have thicker tape on other blades you must replace all 3 pieces.

Precut pieces	#IVOPRTP	\$6.95 each
By the foot	#SST1	\$2.00easst/ft

## ONE TOUCH TACH!



This is the best, most economical one we've found. Easy to use w/auto shut-off, this tool reads in 10rpm increments, and reads 2,3 or 4 blade props with just the touch of a button. Only way to be sure that your prop is actually turning what your tachometer is reading. Remember to multiply by your gear ratio to get proper reading. #ONETT \$49.95

## RK400 Clutch

Indicates Part Replaced by RK400 Clutch

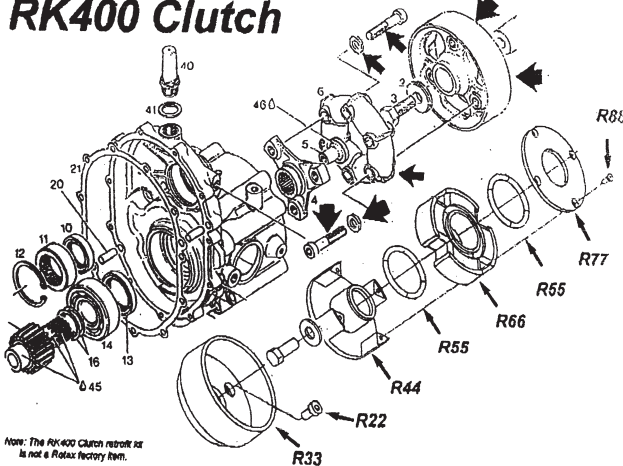

Note: The RK400 Clutch retrofit is not a Rotax factory item.

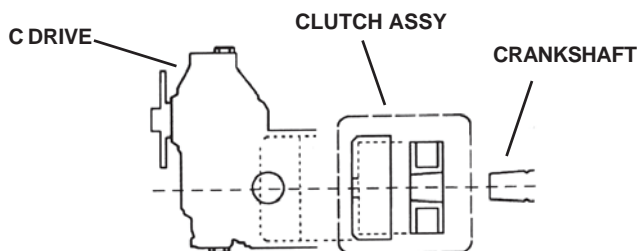

ITEM	Part#	EACH
Clutch assembly	CLUTCH	\$520.00
Adaptor plate	CLUTCHA	\$195.00
M10x16 allen head cap screw(3 rqud)	RK22	\$ .95 ea
Drum	RK33	\$203.00
Drive body	RK44	\$248.00
Spring (2 rqud)	RK55	\$ 13.60
Mechanism w/springs	RK66	\$140.00
Retaining plate	RK77	\$ 60.00
10x24 flat head screw (4 rqud)	RK88	\$ .55 ea

### CLUTCH ASSY

Benefits include:

- \*Engine starts under no load
- \*Clutch does not engage until engine speed is up to approximately 2400 rpm
- \*Engine idle is smoother and vibration is reduced as prop is not moving
- \*Unit weighs less than 3 lbs.
- \*Quick installation
- \*Currently can only be used with drive type C. E drive installation is still being developed as of 4/98. Call for updates.
- \*Adaptor available at additional price to allow C drive to mount on older style 4 hole (A drive) engines. Only available with clutch assy, adds 7/8".
- \*GREAT for towing operations or float aircraft.

# New from Sensenich!

Lighter weight  
Easier to navigate  
Less expensive to fly

## Introducing a Better Propeller for Your Light Sport or Experimental Aircraft.

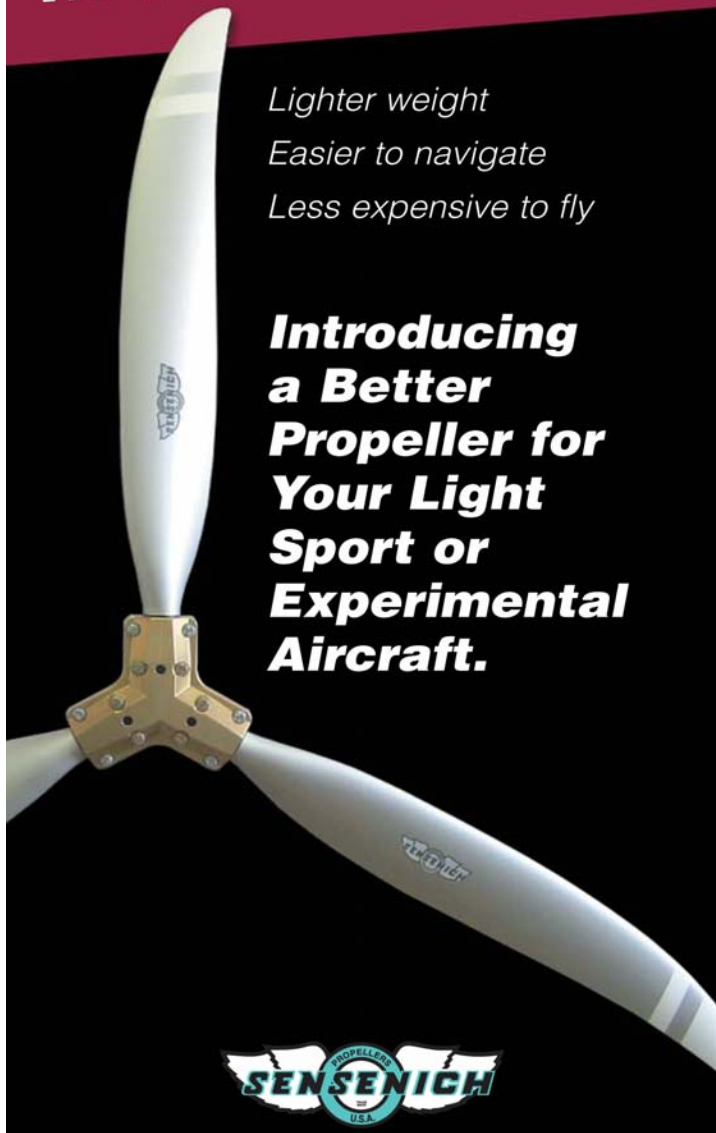

Rotax 2 blade  
Rotax 3 blade

\$1675  
\$2225

### Featuring Revolutionary Sensenich EZ Hub Systems.

Sensenich's new composite propellers work with one of Sensenich's three, all-new hub systems. Featuring patent-pending technology, they are much simpler to use, allowing users to accurately set a pitch without the use of a protractor, special tools or gauges.

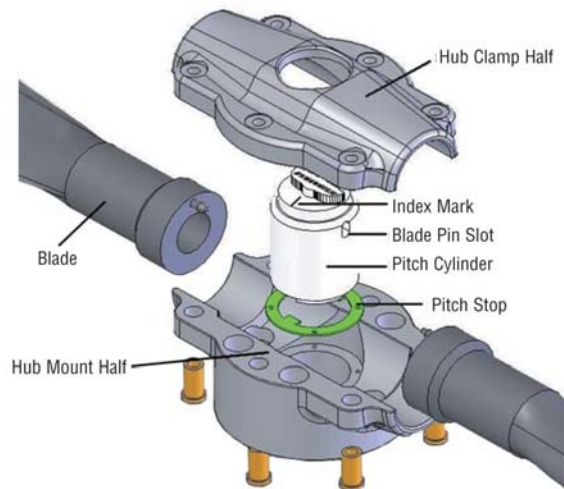

Sensenich's new **Pitch Cylinder Hub System** allows its users to set a broad range of pitches, using the system's index mark as a reference point when making adjustments. They adjust 16 degrees in pitch, affording maximum performance within an efficient aerodynamic envelope. The blade pins lock into the blade pin slot of the pitch cartridge allowing the blades to move back and forth in tandem for ease of setting pitch.

With our new **Pitch Cartridge System** the user can choose from a wide gamut of pitches and set a specific pitch. The blade pins lock into the spring-loaded pitch cartridge, and the pitch is set. To change the pitch, you simply loosen the clamp bolts, replace the pitch cartridge, lock the blade pins in the pitch cartridge and torque the clamp bolts.

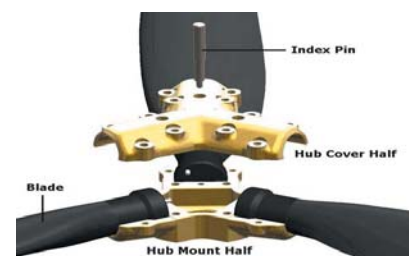

### The Expanding New Line of Sensenich Composite Propellers

Engine	Propeller Model	Propeller Rating	Number Of Blades	Blade Type	Max. Diam.	Min. Diam.	Weight	Hub Notes	Spinner Diam.
Rotax 912, 912s, 914	2A1R5R64DN	115 HP @ 5800 RPM	2	Hi-Speed Tractor	64"	60"		3	12"
Rotax 912, 912s, 914	2A0R5R64EN	115 HP @ 5800 RPM	2	Hi-Speed Tractor	64"	60"		3	9-11"
Rotax 912, 912s, 914	2A0R5L69EN	115 HP @ 5800 RPM	2	Pusher	69"	64"		3	9-11"
Rotax 912, 912s, 914	2A1R5R70DN	115 HP @ 5800 RPM	2	Tractor	70"	66"		3	12"
Rotax 912, 912s, 914	2A0R5R70EN	115 HP @ 5800 RPM	2	Tractor	70"	66"		3	9-11"
Rotax 912, 912s, 914	2A1R5R75DN	115 HP @ 5800 RPM	2	Tractor	75"	70"		3	12"
Rotax 912, 912s, 914	3B0R5R68C	115 HP @ 5800 RPM	3	Tractor	68"	64"	10 lb	3	9-12"

#### Hub Notes

3 Features metal leading edge protection

Lockwood Aviation Supply [www.lockwood-aviation.com](http://www.lockwood-aviation.com)  
Order Line 1-800-LA-ROTAX Info Line 1-863-655-5100

e-mail: [info@lockwood.aero](mailto:info@lockwood.aero)  
Fax Line 1-863-655-6225

## DECALS, STICKERS AND PLACARDS



ALUMINUM

Experimental, #STPWA \$2.25  
Exp Light Sport, #STPWAELS \$2.25  
Special Light Sport, #STPWALS, \$2.25



.020 STAINLESS STEEL  
MEETS FA REQUIREMENTS  
Experimental, #STABS \$2.95  
Light Sport, #STABSLS, \$2.95



"LIGHT SPORT"  
#STLS, Black on white, \$1.95  
"EXPERIMENTAL"  
#STEXPBH, Black on white, horizontal \$2.50  
#STEXPBV, Black, individual letters, vertical \$2.50  
#STEXPWH, White, individual letters, horizontal \$2.50  
#STEXPWV, White, individual letters, vertical \$2.50

EA



#STTP \$2.25

#STAWPVD \$2.50

#STAMS \$2.25

#STPRVD \$2.25



#STPRVD \$2.25



#STSFVD

Set of 2, #STPROP \$2.75



#STRSVD \$2.25

LIFT HERE, NO LIFT, PUSH HERE, NO PUSH  
NO STEP, ALL AVAILABLE IN LETTERS,  
OR BLACK ON SILVER, CHOOSE FROM  
YELLOW, RED, BLUE OR BLACK LETTERS.  
\$2.25 each.



92 Octane #STPVD \$6.50  
90 Octane #STPVD89 \$6.50

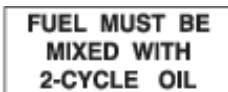

#STROMVD \$1.50

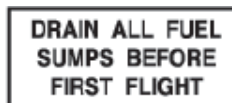

#STDFSVD \$1.50

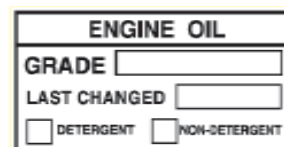

#STEOPVD \$2.25

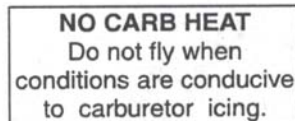

#STNCHVD \$1.50

#STOIPVD \$1.50



#STEPJVD-12 (12V) \$1.50  
#STEPJVD-14 (14V) \$1.50  
#STEPJVD-24 (24V) \$1.50



#STSAVVD \$1.50



**RANGE MARKINGS**  
Kit includes markings for 2" and 3" gauges. Vinyl stick not type. Kit includes complete circles of green, yellow and white with a red line. #STRMD23 \$3.95



100 100LL 100/130 80/87

100 100LL 100/130 80/87

1 2 3 4 5 6 7 8 9 0

1 2 3 4 5 6 7 8 9 0

ITEM BETWEEN NUMBERS WITH 1-KNOTS WHITE



MAY BE PLACED OVER "AVGAS-ONLY" PORTION OF PLACARD

#STUFPVD \$5.95

FOR	N	30	60	E	120/150
STEER					
FOR	S	210/240	W	300/330	
STEER					

#STCC \$.75

DECALS, STICKERS AND PLACARDS



#STDORVD \$2.50



#STDORVDE \$2.50



#STDNO \$1.50



#STCARVD \$1.50

EA



#STBRST \$1.50



#STBRSTS \$2.50



#STEBDVD \$3.50



#STESBW \$1.50



#STESR \$2.50



#STEFVD \$3.50

#STFLUSA \$2.95

#STFLUSAW \$3.50